

# PLAT MAP INDEX

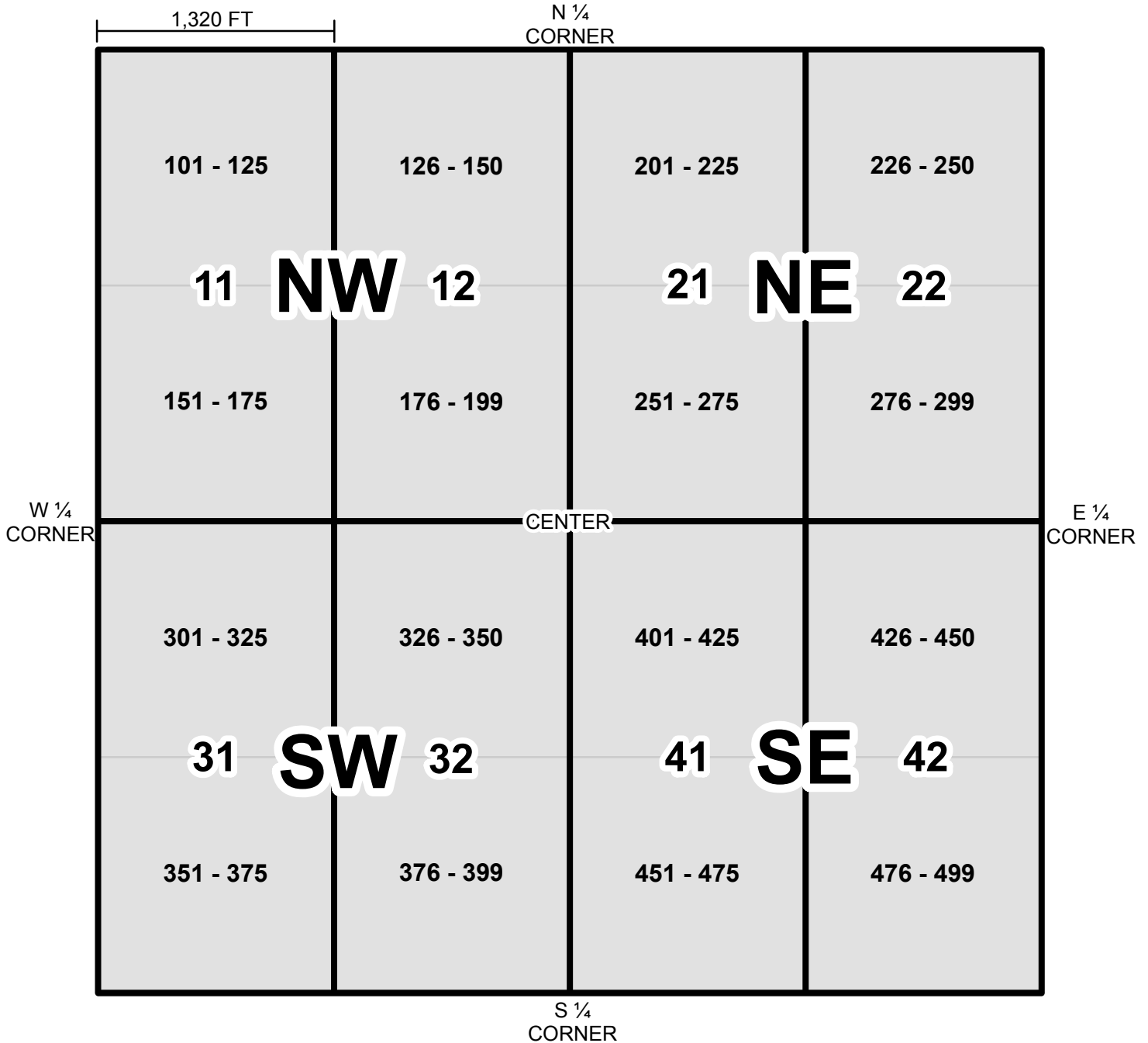

# SECTIONS, LOTS & BLOCKS

## GOVERNMENT TOWNSHIP

4	3	2	1	4	3	2	1	4	3	2	1	4	3	2	1	4	3	2	1
5																			
6	6			5				4				3				2			1
7																			
1																			
2	7			8				9				10				11			12
3																			
4																			
1																			
2	18			17				16				15				14			13
3																			
4																			
1																			
2	19			20				21				22				23			24
3																			
4																			
1																			
2	30			29				28				27				26			25
3																			
4																			
1																			
2	31			32				33				34				35			36
3																			
4																			

## SECTION

NW,NW	NE,NW	NW,NE	NE,NE
NW 1/4		NE 1/4	
(160 Acres)		(160 Acres)	
SW,NW	SE,NW	SW,NE	SE,NE
NW,SW	NE,SW	NW,SE	NE,SE
SW 1/4		SE 1/4	
(160 Acres)		(160 Acres)	
SW,SW	SE,SW	SW,SE	SE,SE
		1320'	1320'
2640'			

5280'

### LOT PLAN 5 ACRE PLATS A & B

11	12
10	13
9	14
8	15
7	16
6	17
5	18
4	19
3	20
2	1

92 Rods

574.2'  
34.8 Rods

### LOT PLAN 10 ACRE PLATS A,B & C

9	10
8	11
7	12
6	13
5	14
4	15
3	16
2	1

92 Rods

287.1'  
17.4 Rods

### SALT LAKE CITY LOT PLANS PLATS D & G

3	4
2	1

10 Rods

165'  
10 Rods

### PLATS A,B,C & F

5	6
4	7
3	8
2	1

20 Rods

330'  
10 Rods

### PLATS A,B,C & F

5	6	7	8
4	3	2	1

20 Rods

330'  
165'  
10 Rods

### SALT LAKE CITY SURVEY:

Streets lying between blocks in Plats D & G are 5 Rods (82.5') in width.  
 Streets lying between blocks in Plats A,B,C & F are 8 Rods (132') in width.  
 Plats E, I, J & K are irregular.  
 Streets lying between blocks in Plats E, I, J & K have varying widths.

### BIG FIELD SURVEY:

All streets lying between blocks are 4 Rods (66') in width.

1 Link = .66 feet  
 1 Rod = 16.5 feet  
 1 Chain = 66 feet  
 1 Acre = 43560 feet

13 Below are some charts to help illustrate the lot layouts for Salt Lake City Survey/Big Field survey.

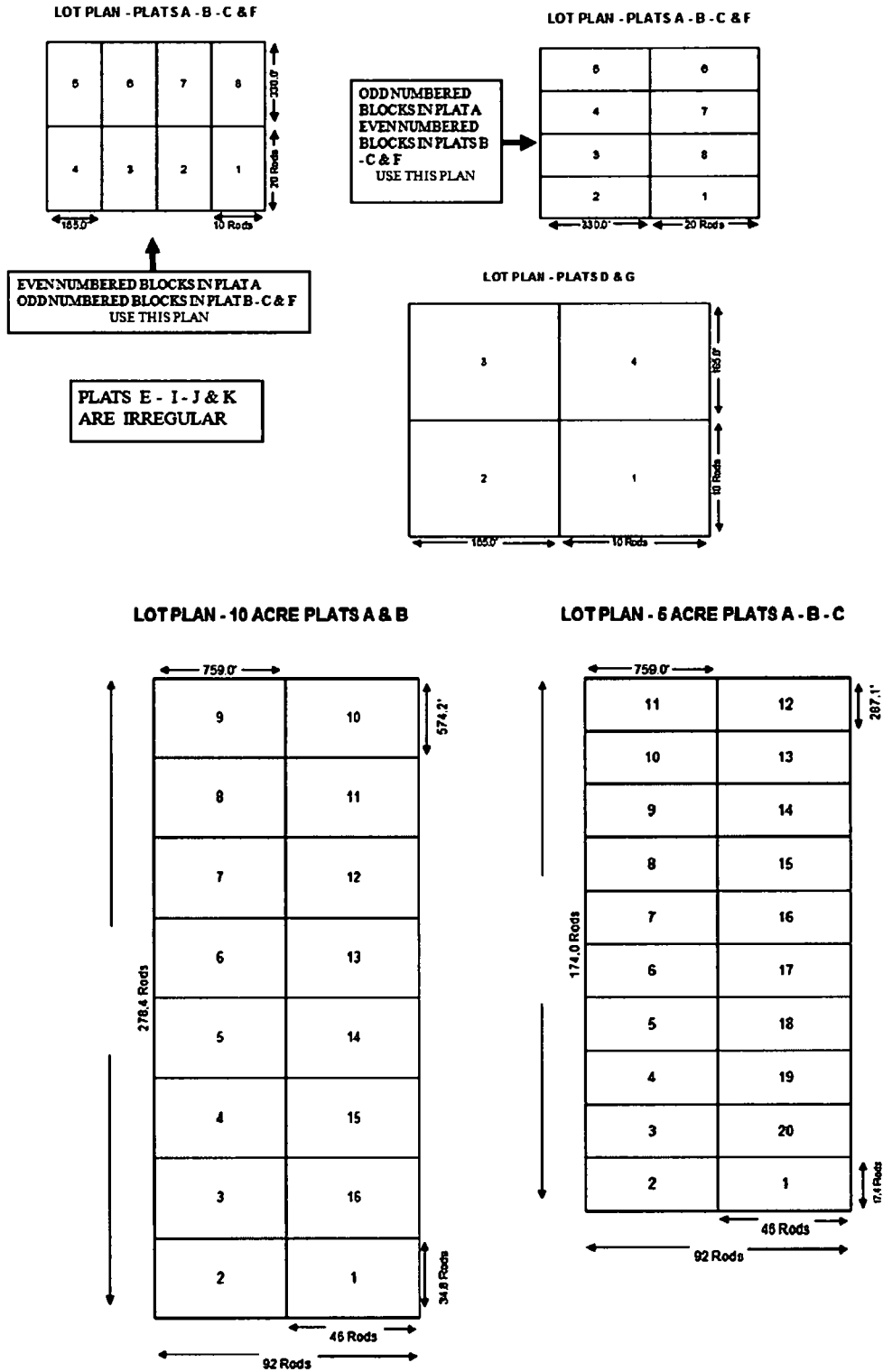

# SECTION DIVISIONS

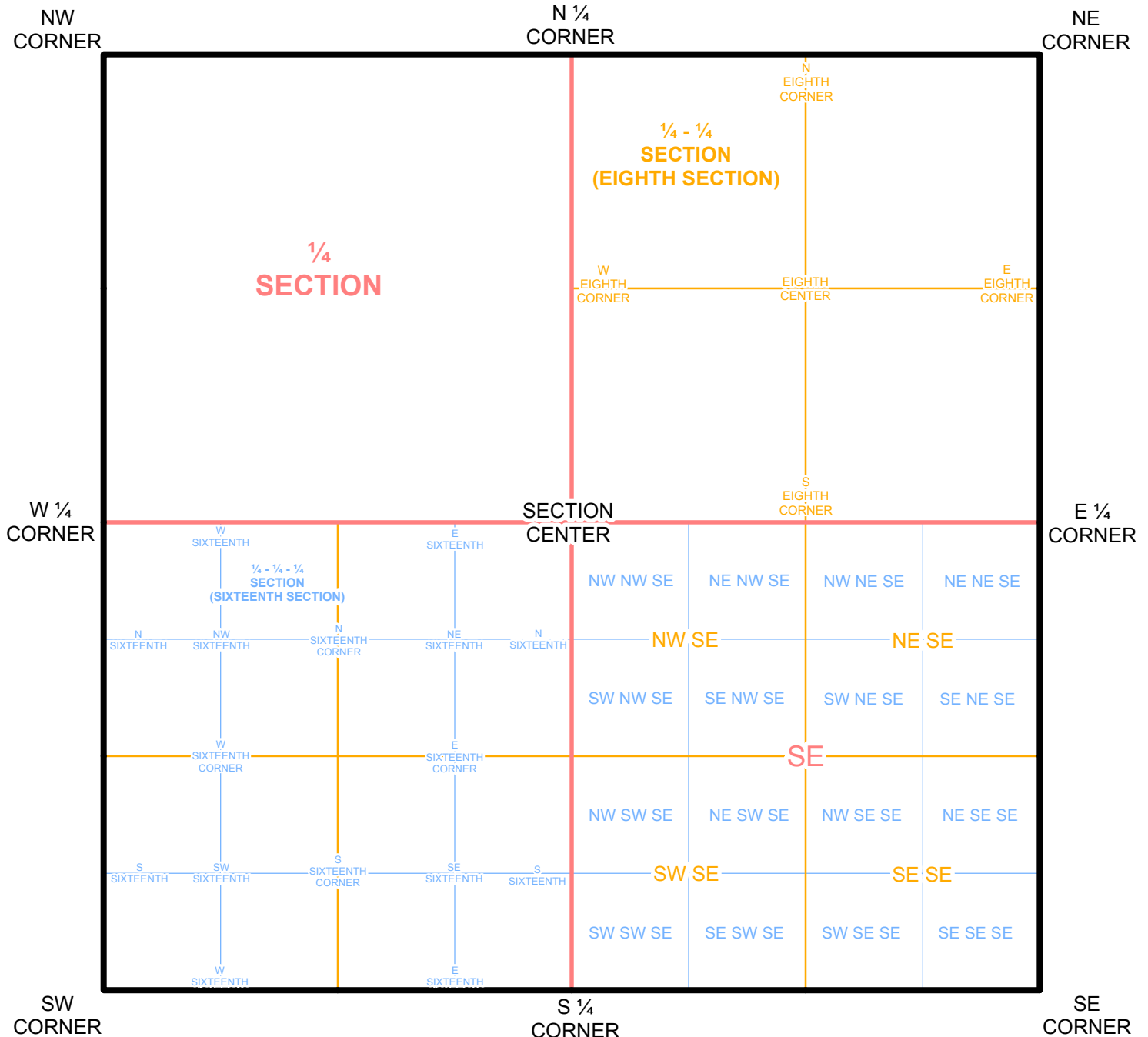

# A SECTION OF LAND — 640 ACRES

Chains Rods Feet  
Quarter Sections and Subdivisions Thereof

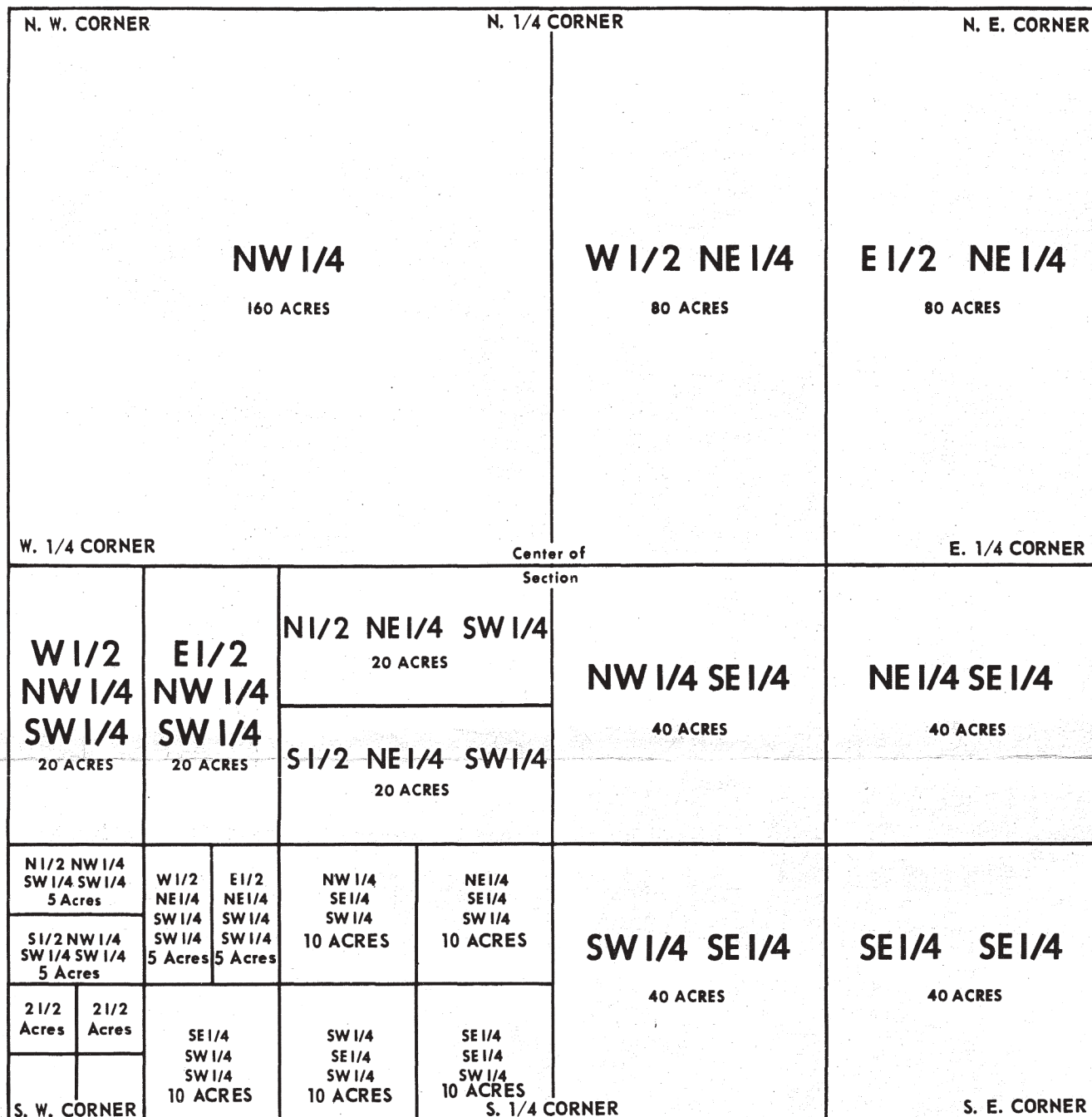

Copyright, 1952, James Hamilton Adair, Flint, Michigan.

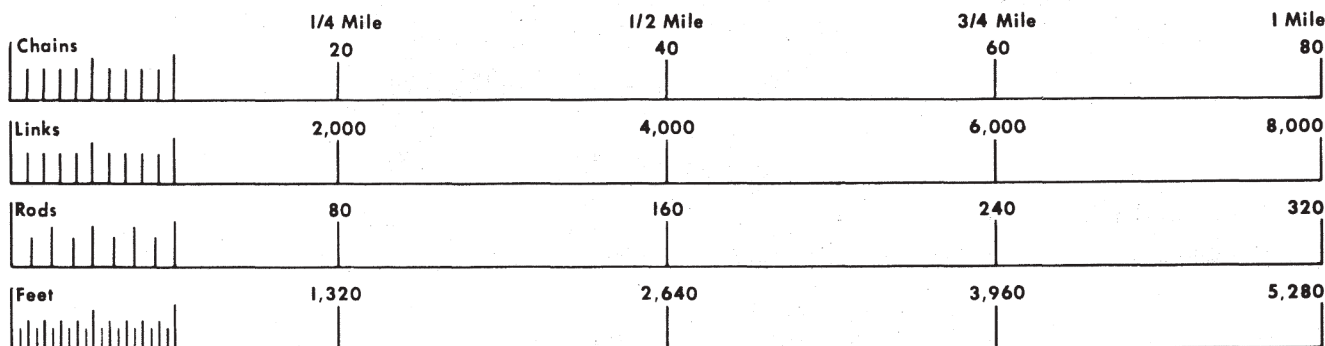

Always on rectangular survey descriptions, work from end of description back to the beginning. Example:

1	2	3	4	5&6	7
Town and Range	Sec. Number	¼ section	¼ sec. of ¼ sec.	thence into halves or quarters to beginning	
South 165 feet of 5 Acres	S ½ 10 Acres	S ½ 20 Acres	SE ¼ 40 Acres	NE ¼ 160 Acres	Section 8 640 Acres
					Town 7 North, Range 7 East

The preferred order in locating quarter sections is counter-clockwise, North East quarter, North West quarter, South West quarter, and South East quarter. If parts of the quarter sections are to be described, the same order should be observed.

**UNITS OF LENGTH**

Units	Inches	Links	Feet	Yards	Rods	Chains	Miles
1 inch =	1	0.126263	0.0833333	0.0277778	0.00505051	0.00126263	0.0000157828
1 link =	7.92	1	0.66	0.22	0.04	0.01	0.000125
1 foot =	12	1.515152	1	0.333333	0.0606061	0.0151515	0.0001893939
1 yard =	36	4.54545	3	1	0.181818	0.0454545	0.000568182
1 rod =	198	25	16.5	5.5	1	0.25	0.003125
1 chain =	792	100	66	22	4	1	0.0125
1 mile =	63,360	8,000	5,280	1,760	320	80	1

AREA MEASURE			GUNTER'S OR SURVEYOR'S CHAIN MEASURE		
144 square inches =	1 square foot	1 acre =	43,560 square feet	7.92 inches =	1 link
9 square feet =	1 square yard	640 acres =	1 square mile	100 links =	1 chain
30 1/4 square yards =	1 square rod	1 mile square =	1 section	4 rods =	66 feet or 1 chain
1 square rod =	272.25 square feet	6 miles square =	1 township	80 chains =	1 statute mile
160 square rods =	1 acre	36 sections =	36 square miles	(Courtesy National Bureau of Standards)	
1 acre =	4,840 square yards				

**Conversion of Chains to Rods and Feet**

**Links in Feet and Inches**

Chains	Rods	Feet	Chains	Rods	Feet	Chains	Rods	Feet	Links	Feet	Inches	Links	Feet	Inches	Links	Feet	Inches
1	16.5		14	56	924.	27	108	1782.	1	0	7.92	34	22	5.28	67	44	2.64
2	33.			57	940.5		109	1798.5	2	1	3.84	35	23	1.20	68	44	10.56
3	49.5			58	957.		110	1815.	3	1	11.76	36	23	9.12	69	45	6.48
4	66.			59	973.5		111	1831.5	4	2	7.68	37	24	5.04	70	46	2.40
5	82.5		15	60	990.	28	112	1848.	5	3	3.60	38	25	0.96	71	46	10.32
6	99.			61	1006.5		113	1864.5	6	3	11.52	39	25	8.88	72	47	6.24
7	115.5			62	1023.		114	1881.	7	4	7.44	40	26	4.80	73	48	2.16
8	132.			63	1039.5		115	1897.5	8	5	3.36	41	27	0.72	74	48	10.08
9	148.5		16	64	1056.	29	116	1914.	9	5	11.28	42	27	8.64	75	49	6.00
10	165.			65	1072.5		117	1930.5	10	6	7.20	43	28	4.56	76	50	1.92
11	181.5			66	1089.		118	1947.	11	7	3.12	44	29	0.48	77	50	9.84
12	198.		17	67	1105.5	30	119	1963.5	12	7	11.04	45	29	8.40	78	51	5.76
13	214.5			68	1122.		120	1980.	13	8	6.96	46	30	4.32	79	52	1.68
14	231.			69	1138.5		121	1996.5	14	9	2.88	47	31	0.24	80	52	9.60
15	247.5		18	70	1155.	31	122	2013.	15	9	10.80	48	31	8.16	81	53	5.52
16	264.			71	1171.5		123	2029.5	16	10	6.72	49	32	4.08	82	54	1.44
17	280.5			72	1188.		124	2046.	17	11	2.64	50	33	0.00	83	54	9.36
18	297.		19	73	1204.5	32	125	2062.5	18	11	10.56	51	33	7.92	84	55	5.28
19	313.5			74	1221.		126	2079.	19	12	6.48	52	34	3.84	85	56	1.20
20	330.			75	1237.5		127	2095.5	20	13	2.40	53	34	11.76	86	56	9.12
21	346.5		20	76	1254.	33	128	2112.	21	13	10.32	54	35	7.68	87	57	5.04
22	363.			77	1270.5		129	2128.5	22	14	6.24	55	36	3.60	88	58	0.96
23	379.5			78	1287.		130	2145.	23	15	2.16	56	36	11.52	89	59	8.88
24	396.		21	79	1303.5	34	131	2161.5	24	15	10.08	57	37	7.44	90	59	4.80
25	412.5			80	1320.		132	2178.	25	16	6.00	58	38	3.36	91	60	0.72
26	429.		22	81	1336.5	35	133	2194.5	26	17	1.92	59	38	11.28	92	60	8.64
27	445.5			82	1353.		134	2211.	27	17	9.84	60	39	7.20	93	61	4.56
28	462.			83	1369.5		135	2227.5	28	18	5.76	61	40	3.12	94	62	0.48
29	478.5		23	84	1386.	36	136	2244.	29	19	1.68	62	40	11.04	95	62	8.40
30	495.			85	1402.5		137	2260.5	30	19	9.60	63	41	6.96	96	63	4.32
31	511.5			86	1419.		138	2277.	31	20	5.52	64	42	2.88	97	64	0.24
32	528.		24	87	1435.5	37	139	2293.5	32	21	1.44	65	42	10.80	98	64	8.16
33	544.5			88	1452.		140	2310.	33	21	9.36	66	43	6.72	100	66	0.00
34	561.			89	1468.5		141	2326.5									
35	577.5		25	90	1485.	38	142	2343.									
36	594.			91	1501.5		143	2359.5									
37	610.5			92	1518.		144	2376.									
38	627.		26	93	1534.5	39	145	2392.5									
39	643.5			94	1551.		146	2409.									
40	660.			95	1567.5		147	2425.5									
41	676.5		27	96	1584.	40	148	2442.									
42	693.			97	1600.5		149	2458.5									
43	709.5			98	1617.		150	2475.									
44	726.		28	99	1633.5	41	151	2491.5									
45	742.5			100	1650.		152	2508.									
46	759.			101	1666.5		153	2524.5									
47	775.5		29	102	1683.	42	154	2541.									
48	792.			103	1699.5		155	2557.5									
49	808.5			104	1716.		156	2574.									
50	825.		30	105	1732.5	43	157	2590.5									
51	841.5			106	1749.		158	2607.									
52	858.			107	1765.5		159	2623.5									
53	874.5		31			44											
54	891.																
55	907.5																

(Copyright, 1952, James Hamilton Adair, Flint, Michigan.)

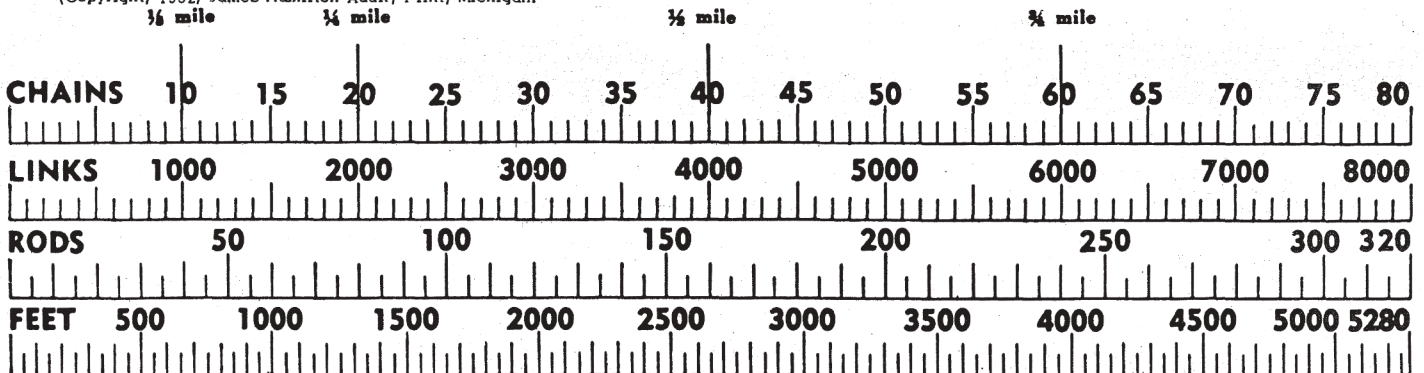

# INDEXING AND LOCATING PLATS

There are a couple of ways to locate a plat map. You can locate it by using a subdivision name, or by using a parcel number. You can view Parcel Plat Maps and Subdivision Maps by name or parcel number in Data Services.

If you want to locate the correct plat map using only a parcel number, you will need to understand a simple indexing system. In the following diagrams a sample parcel number, **16-19-302-008**, is broken down to illustrate the indexing system. Using the indexing system you will be able to locate any plat map using only a parcel number.

The first example will show indexing for 1" = 100' plat maps.

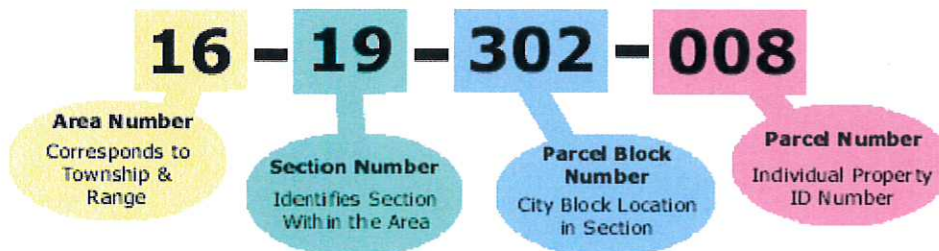



# AREA NUMBER

The area number is directly related to a township and range within Salt Lake County, as shown on the following Salt Lake County map.

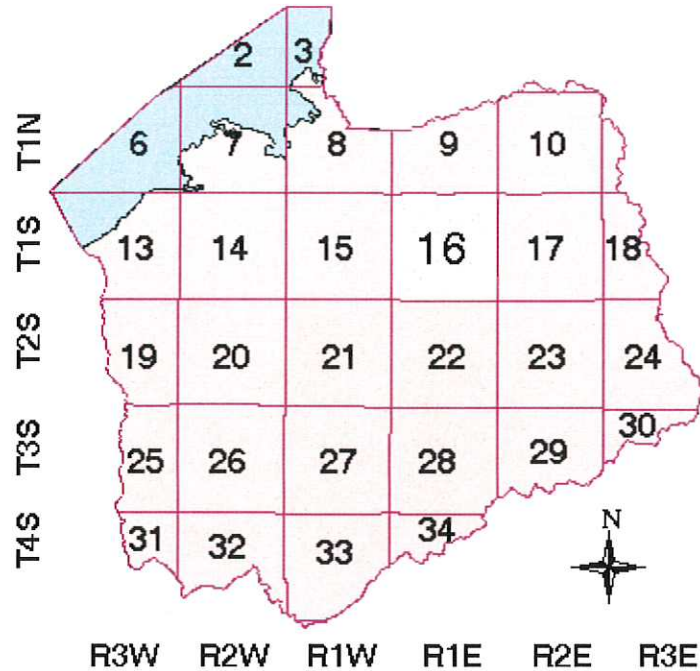

**16-19-302-008**

# SECTION NUMBER

The section number is sometimes referred to as the sub area number within the township. There are 36 sections in every township.

6	5	4	3	2	1
7	8	9	10	11	12
18	17	16	15	14	13
19	20	21	22	23	24
30	29	28	27	26	25
31	32	33	34	35	36

**16-19-302-008**



# PARCEL BLOCK NUMBER

The parcel block number will numerically define the 1/4 section, and the 1/4 of the 1/4 section, in which the parcel (lot) is located.

<b>PLAT NUMBER</b> 16-19-11  BLOCKS 101-125	<b>PLAT NUMBER</b> 16-19-12  BLOCKS 126-150	<b>PLAT NUMBER</b> 16-19-21  BLOCKS 201-225	<b>PLAT NUMBER</b> 16-19-22  BLOCKS 226-250
<b>N.W. 1/4</b> <b>(100)</b>		<b>N.E. 1/4</b> <b>(200)</b>	
BLOCKS 151-175	BLOCKS 176-199	BLOCKS 251-275	BLOCKS 276-299
BLOCKS 301-325	BLOCKS 326-350	BLOCKS 401-425	BLOCKS 426-450
<b>S.W. 1/4</b> <b>(300)</b>		<b>S.E. 1/4</b> <b>(400)</b>	
BLOCKS 351-375	BLOCKS 376-399	BLOCKS 451-475	BLOCKS 476-499
<b>PLAT NUMBER</b> 16-19-31	<b>PLAT NUMBER</b> 16-19-32	<b>PLAT NUMBER</b> 16-19-41	<b>PLAT NUMBER</b> 16-19-42

**16-19-302-008**

# INDEXING OF 1" = 50' PLATS

The following example shows plat indexing for 1" = 50' plat maps.

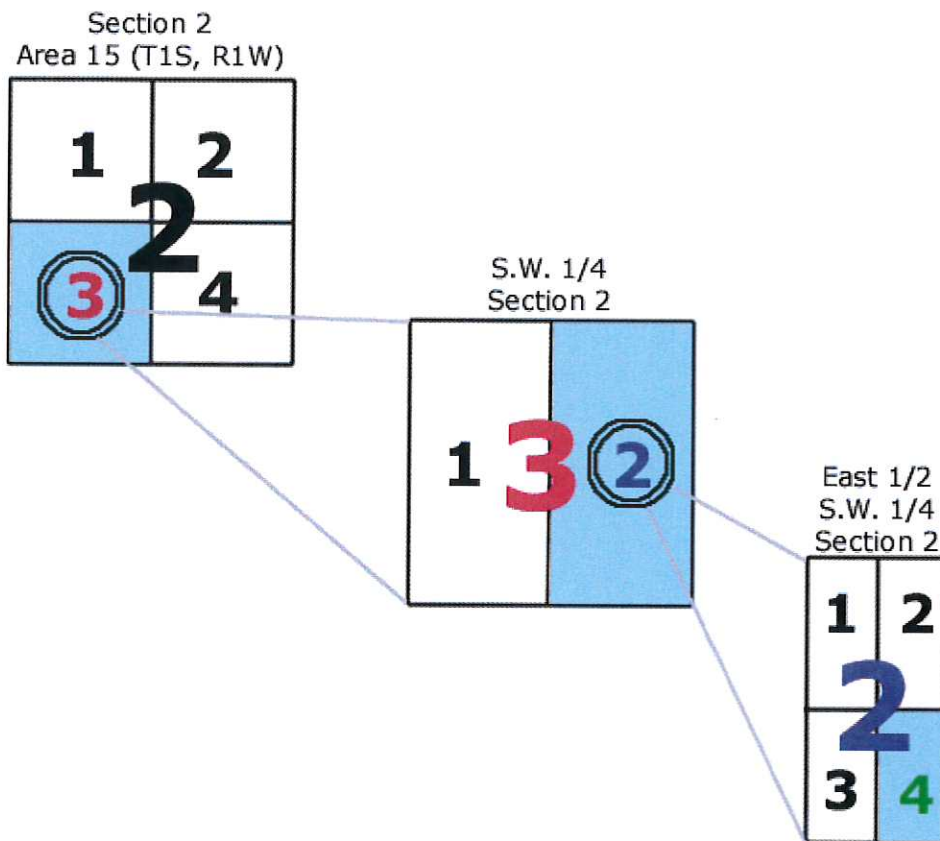
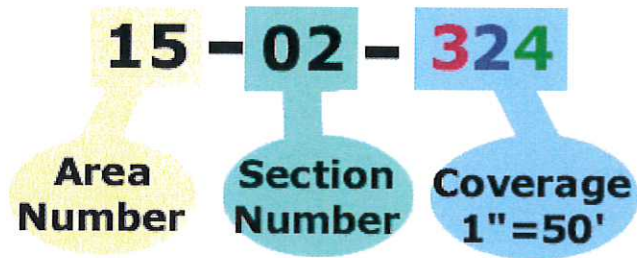

# INDEXING OF 1" = 400' PLATS

The following example shows plat indexing for 1" = 400' plat maps. This scale is used in locations that are less densely segregated.

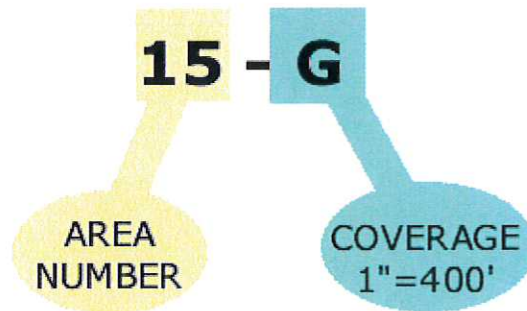

## AREA 15

6	5	4	3	2	1
<b>A</b>	<b>B</b>	<b>C</b>	<b>D</b>	<b>E</b>	<b>F</b>
7	8	9	10	11	12
18	17	16	15	14	13
<b>G</b>	<b>H</b>	<b>J</b>	<b>K</b>	<b>L</b>	<b>M</b>
19	20	21	22	23	24
30	29	28	27	26	25
<b>N</b>	<b>O</b>	<b>P</b>	<b>Q</b>	<b>R</b>	<b>S</b>
31	32	33	34	35	36

# PARCEL NUMBER

The parcel number identifies the specific subdivision lot or metes and bounds parcel, as shown on the plat map.

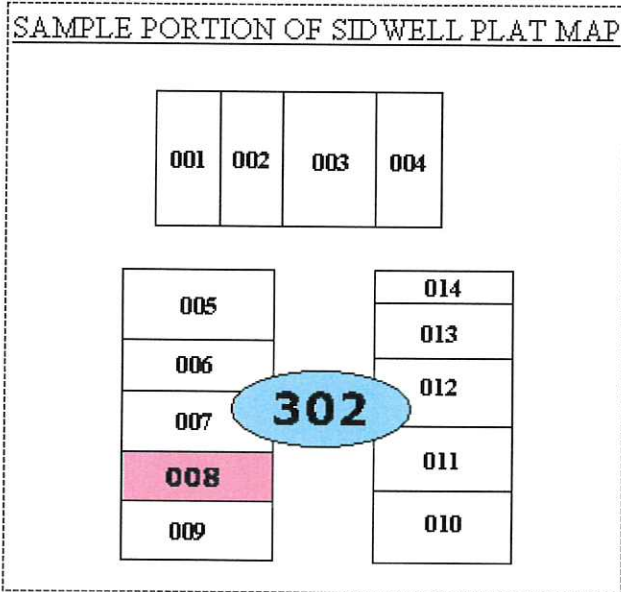

**16-19-302-008**

# ENCUMBRANCE NUMBER

---

An encumbrance number is used when the permanent parcel number may need to have multiple tax records. Encumbrance numbers are assigned as follows:

- **1001-1999 -- UNDIVIDED INTERESTS**  
When more than one owner has an interest in the property.
- **2000-2999 -- LAND CARD**  
Improvements on leased land:  
2000 - Land only  
2001 - Improvements
- **3000-3999 -- AIR RIGHTS**  
The right to undisturbed use and control of designated airspace above a specific land area within stated elevations. Such rights may be acquired to construct a building above the land or the building of another, or to protect the light and air of an existing or proposed structure on an adjoining lot. (Definition from *The Appraisal of Real Estate*, 12th Ed.)
- **4000-4999 -- TAX DISTRICTS**  
When a parcel is split into more than one tax district.
- **5000-5999 -- MINING CLAIMS**  
Note: Not all mining claims have encumbrance numbers on them, and some mining claims may be assessed by the State of Utah.
- **6000-6999 -- PRIVILEGE TAX**  
Used when ownership is exempt and leased out.
- **7000-7999**  
Combinations of the above categories; for example, an undivided interest in a parcel divided by a tax district boundary.
- **8000-8999**  
Privilege taxes on yield basis for Greenbelt.
- **9000-9999 -- MOBILE HOMES**